

APPLICATION FOR PLANNING APPROVAL

Application Number: DA-2026-172
Proposal: Stormwater infrastructure upgrade within road reserve
Subject Site: Belhaven Avenue Road Reserve (CT199086/1 & CT 249198/1), Taroona
Responsible Planning Officer: Cassinia Devries

Advertised Documents:

- Application Plans
- Landslide Hazard Report

Available upon request:

- Application Form
- Copy of Title

NOTE: The documents included for advertising (public notice) have been provided by the applicant. The advertising of the documentation does not confirm that Council agrees with, or endorses, the content or assessments.

Representations:

Representations must be provided in writing to Council stating the reasons why you support or object to the application. Representations for this application must be submitted by 11.59pm on **26 June 2026**; and can be delivered in person to the Civic Centre, posted to Locked Bag 1, Kingston 7050 or emailed to kc@kingborough.tas.gov.au.



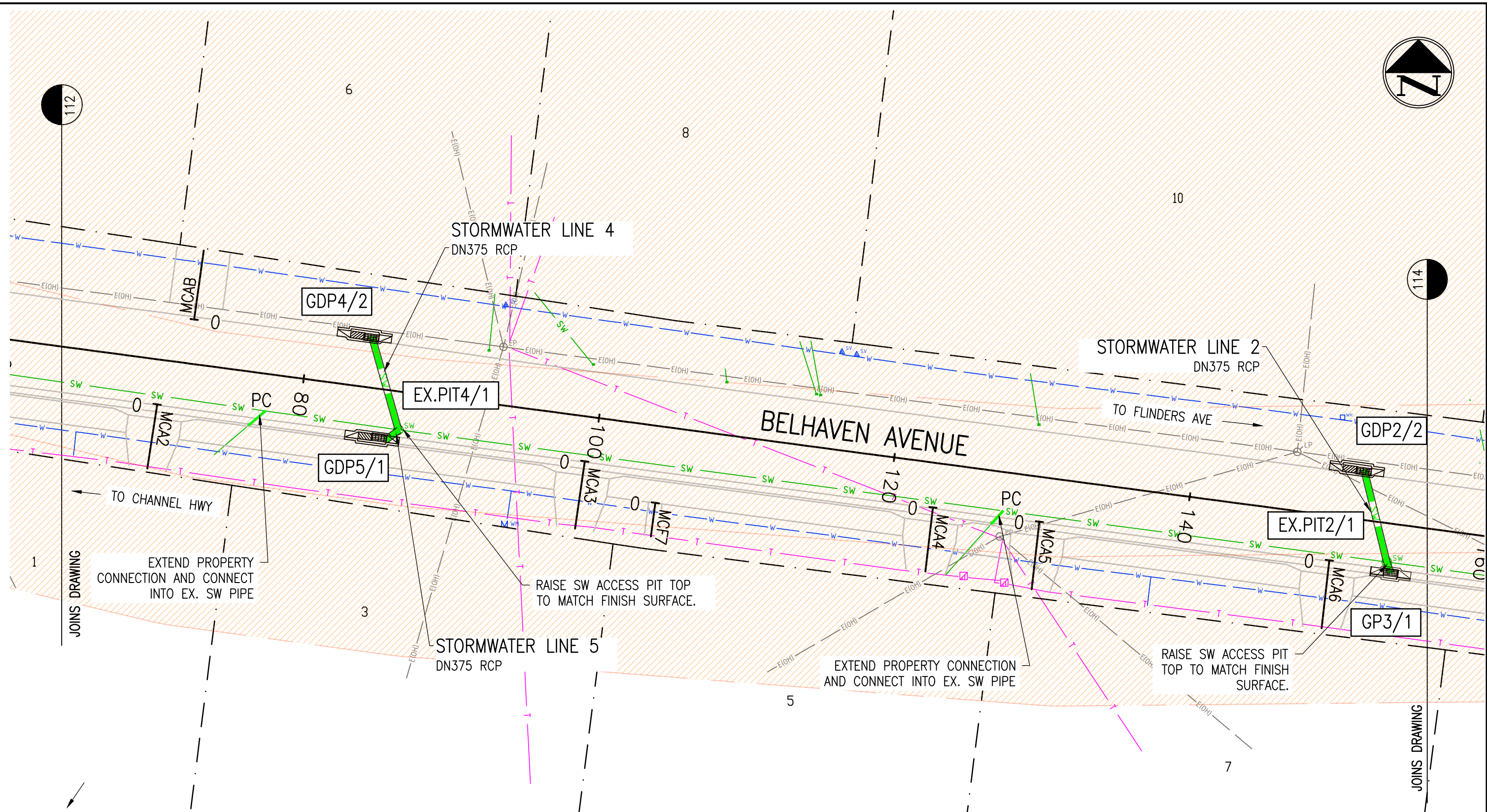

Kingborough Council

Development Application: DA-2026-172

Plan Reference No: P1

Date Received: 7/5/2026

Date placed on Public Exhibition: 13/6/2026

BEWARE OF UNDERGROUND SERVICES
 THE LOCATION OF UNDERGROUND SERVICES ARE APPROXIMATE ONLY AND THEIR EXACT LOCATION SHOULD BE PROVEN ON SITE BY THE RELEVANT AUTHORITIES. NO GUARANTEE IS GIVEN THAT ALL SERVICES ARE SHOWN.
 THE CONTRACTOR SHALL DETERMINE THE LOCATION OF ALL UNDERGROUND SERVICES PRIOR TO COMMENCEMENT OF WORKS.

Copyright - "This document is and shall remain the property of Kingborough Council. The document may only be used for the purpose for which it was designed. Unauthorised use of this document in any way is prohibited". ©

SCALE 1:250
 0.0 2.5 5.0 7.5 10.0 12.5 m

COORDINATE SYSTEM	GDA20 ZONE55	HEIGHT DATUM	AHD83
A3 ORIGINAL		DO NOT SCALE	

PREPARED BY ENGINEERING SERVICES			
SURVEYED	UDM	PROJECT ENGINEER	
DESIGNED	T. BOWDEN	PROJECT ENGINEER	
DRAWN	T. BOWDEN	PROJECT MANAGER	
CHECKED			
DIRECTOR ENGINEERING SERVICES		/ / DATE	



Kingborough Council
 Civic Centre, 15 Channel Highway, Kingston, Tasmania 7050
 Postal Address: Locked Bag 1, Kingston, Tasmania 7050
 Telephone (03) 6211 8200 | Fax (03) 6211 8211
 Email kc@kingborough.tas.gov.au | Internet www.kingborough.tas.gov.au

BELHAVEN AVENUE (VIC 2-12), TAROONA
BETWEEN NORWOOD AVENUE AND MEATH AVENUE
RECONSTRUCTION
EX. SERVICES, SETOUT AND STORMWATER PLAN 2

SHEET	14 OF 52 SHEETS
ACCOUNT:	C03645
REV.	
CONTRACT/DRAWING NUMBER	3281-114

DRAWING DETAILS: S:\technical\services\job_folders\3281-114\116 EX. Services, Setout and Stormwater Plan.dwg
 PLOTTED: 08 March 2026 11:12 AM - KKONG

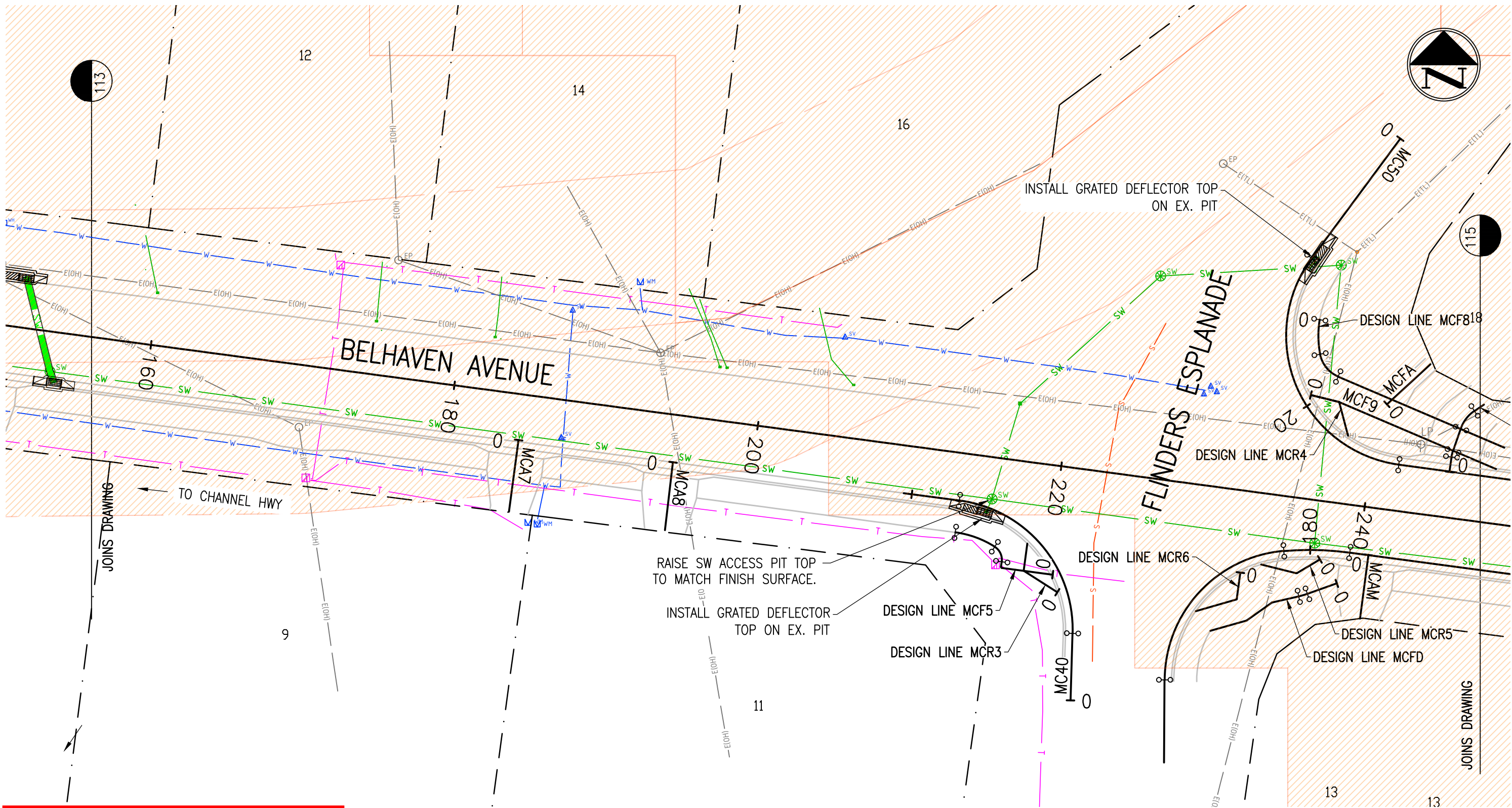

Kingborough Council

Development Application: DA-2026-172

Plan Reference No: P1

Date Received: 7/5/2026

Date placed on Public Exhibition: 13/6/2026

BEWARE OF UNDERGROUND SERVICES
 THE LOCATION OF UNDERGROUND SERVICES ARE APPROXIMATE ONLY AND THEIR EXACT LOCATION SHOULD BE PROVEN ON SITE BY THE RELEVANT AUTHORITIES. NO GUARANTEE IS GIVEN THAT ALL SERVICES ARE SHOWN.
 THE CONTRACTOR SHALL DETERMINE THE LOCATION OF ALL UNDERGROUND SERVICES PRIOR TO COMMENCEMENT OF WORKS.

Copyright - "This document is and shall remain the property of Kingborough Council. The document may only be used for the purpose for which it was designed. Unauthorised use of this document in any way is prohibited". ©

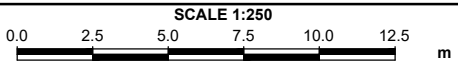

PREPARED BY ENGINEERING SERVICES			
SURVEYED	UDM	PROJECT ENGINEER	
DESIGNED	T. BOWDEN	PROJECT ENGINEER	
DRAWN	T. BOWDEN	PROJECT ENGINEER	
CHECKED		PROJECT MANAGER	



Kingborough Council
 Civic Centre, 15 Channel Highway, Kingston, Tasmania 7050
 Postal Address: Locked Bag 1, Kingston, Tasmania 7050
 Telephone (03) 6211 8200 | Fax (03) 6211 8211
 Email kc@kingborough.tas.gov.au | Internet www.kingborough.tas.gov.au

BELHAVEN AVENUE (VIC 2-12), TAROONA
BETWEEN NORWOOD AVENUE AND MEATH AVENUE
RECONSTRUCTION
EX. SERVICES, SETOUT AND STORMWATER PLAN 3

SHEET	15 OF 52 SHEETS
ACCOUNT:	C03645
REV.	
CONTRACT/DRAWING NUMBER	3281-115

COORDINATE SYSTEM	GDA20 ZONE55	HEIGHT DATUM	AHD83
A3 ORIGINAL		DO NOT SCALE	

DIRECTOR ENGINEERING SERVICES / / DATE

No.	DESCRIPTION	DATE	INITIAL
-----	-------------	------	---------

REVISIONS			

Document Set ID: 4780907

Version: 1, Version Date: 10/06/2026

Version: 1, Version Date: 10/06/2026

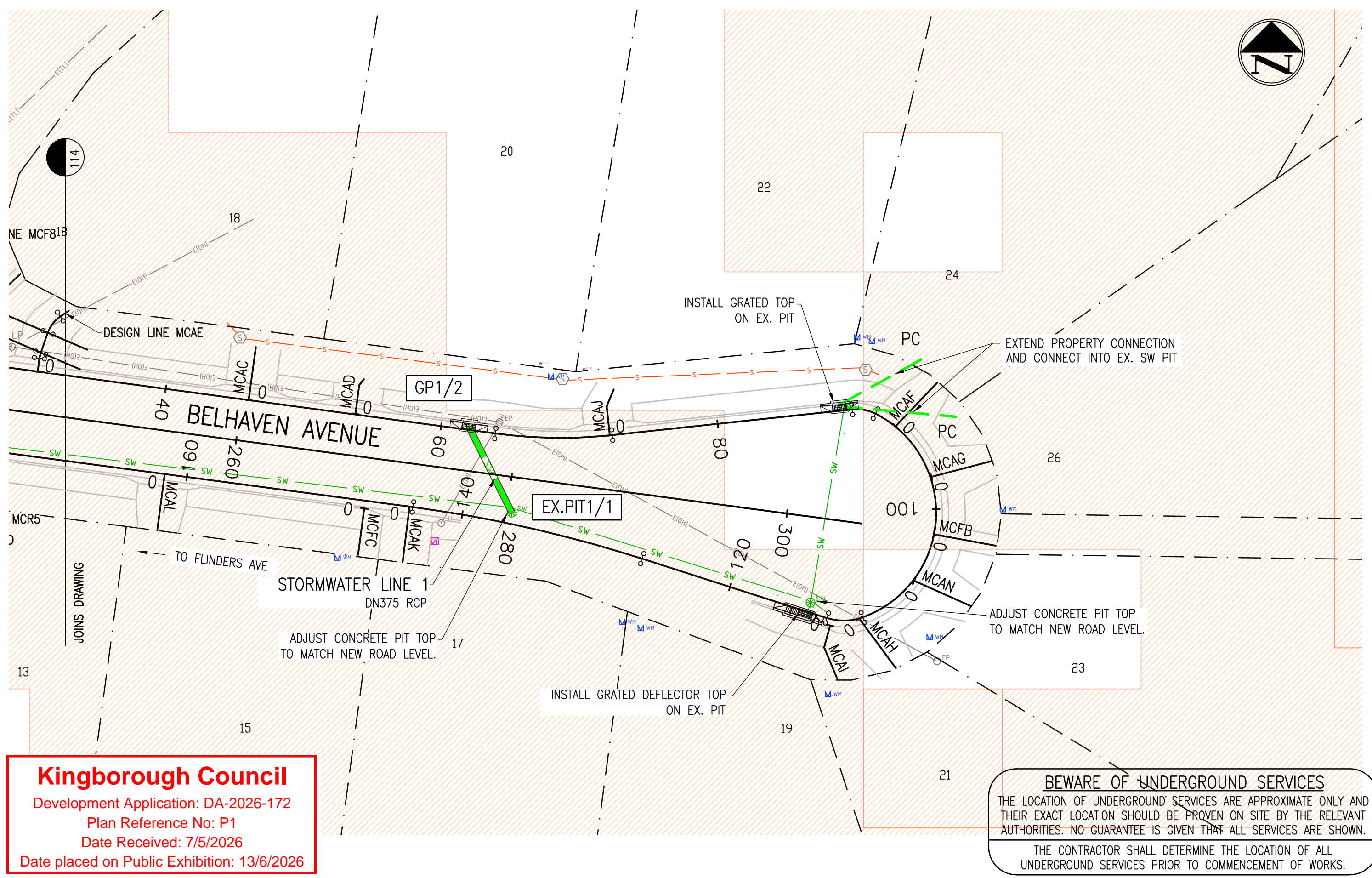

Kingborough Council
 Development Application: DA-2026-172
 Plan Reference No: P1
 Date Received: 7/5/2026
 Date placed on Public Exhibition: 13/6/2026

BEWARE OF UNDERGROUND SERVICES
 THE LOCATION OF UNDERGROUND SERVICES ARE APPROXIMATE ONLY AND THEIR EXACT LOCATION SHOULD BE PROVEN ON SITE BY THE RELEVANT AUTHORITIES. NO GUARANTEE IS GIVEN THAT ALL SERVICES ARE SHOWN.
 THE CONTRACTOR SHALL DETERMINE THE LOCATION OF ALL UNDERGROUND SERVICES PRIOR TO COMMENCEMENT OF WORKS.

Copyright - "This document is and shall remain the property of Kingborough Council. The document may only be used for the purpose for which it was designed. Unauthorised use of this document in any way is prohibited". ©

SCALE 1:250
 0.0 2.5 5.0 7.5 10.0 12.5 m

No.	DESCRIPTION	DATE	INITIAL
REVISIONS			

COORDINATE SYSTEM | GDA20 ZONE55 | HEIGHT DATUM | AHD83
 A3 ORIGINAL | DO NOT SCALE

PREPARED BY ENGINEERING SERVICES			
SURVEYED	UDM	PROJECT ENGINEER	
DESIGNED	T. BOWDEN	PROJECT ENGINEER	
DRAWN	T. BOWDEN	PROJECT MANAGER	
CHECKED			
DIRECTOR ENGINEERING SERVICES		/ /	DATE



Kingborough Council
 Civic Centre, 15 Channel Highway, Kingston, Tasmania 7050
 Postal Address: Locked Bag 1, Kingston, Tasmania 7050
 Telephone (03) 6211 8200 | Fax (03) 6211 8211
 Email kc@kingborough.tas.gov.au | Internet www.kingborough.tas.gov.au

BELHAVEN AVENUE (VIC 2-12), TAROONA
BETWEEN NORWOOD AVENUE AND MEATH AVENUE
 RECONSTRUCTION
 EX. SERVICES, SETOUT AND STORMWATER PLAN 4

SHEET	16 OF 52 SHEETS
ACCOUNT:	C03645
REV.	
CONTRACT/DRAWING NUMBER	3281-116

LEGEND

 COMPACTED 20mm F.C.R. BACKFILL IN LAYERS OF 150mm MAX

- o s EX SEWER MAIN
- o w EX WATER MAIN
- o t EX TELSTRA
- GP GRATED PIT
- GDP GRATED DEFLECTOR PIT

NOTE

1. CLASS D TRAFFICABLE LIDS AND SURROUNDS UNLESS OTHERWISE NOTED.
2. SHORING AS REQUIRED.
3. PP STORMWATER PIPES TO BE CLASS 'SN8' OR EQUIVALENT.
4. RCP STORMWATER PIPES TO BE CLASS 4 OR EQUIVALENT.
5. EX. SERVICES TO BE LOCATED AND DEPTH TO BE CONFIRMED PRIOR TO CONSTRUCTION.

EX.PIT1/1 GP1/2

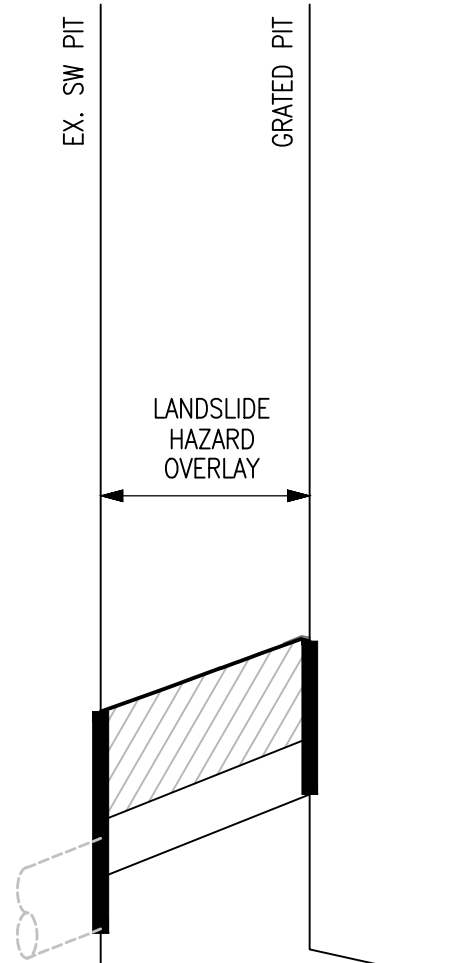

PIPE DETAILS GRADE		DN375 RCP 8.0%	
DATUM RL 15			
DEPTH TO INVERT	1.098		1.013
INVERT LEVEL	16.360 16.700		17.250
FINISHED SURFACE	17.798		18.263
EXISTING SURFACE	17.795		18.286
CHAINAGE	0.000	6.915	6.915

STORMWATER LINE 1

EX.PIT2/1 GDP2/2

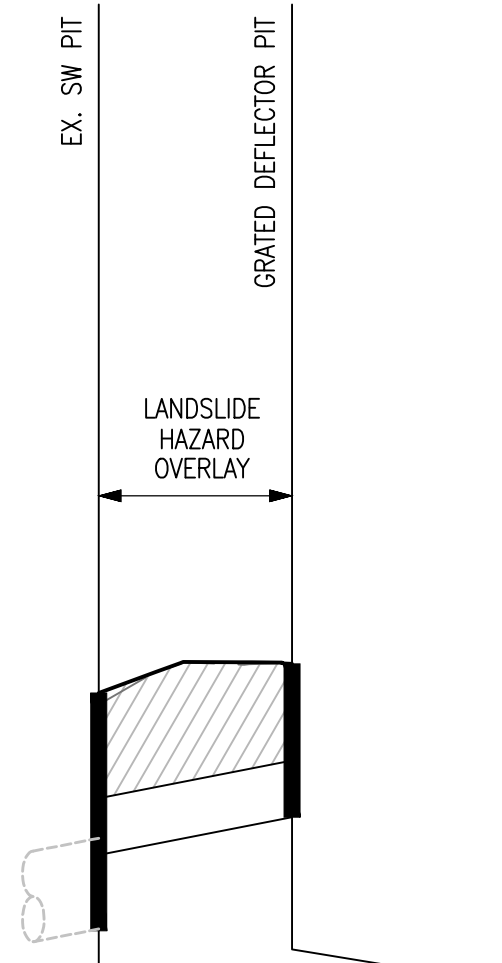

PIPE DETAILS GRADE		DN375 RCP 3.9%	
DATUM RL 28			
DEPTH TO INVERT	1.072		1.013
INVERT LEVEL	29.360 29.850		30.100
FINISHED SURFACE	30.922		31.113
EXISTING SURFACE	30.845		31.113
CHAINAGE	0.000	6.385	6.385

STORMWATER LINE 2

EX.PIT2/1 GP3/1

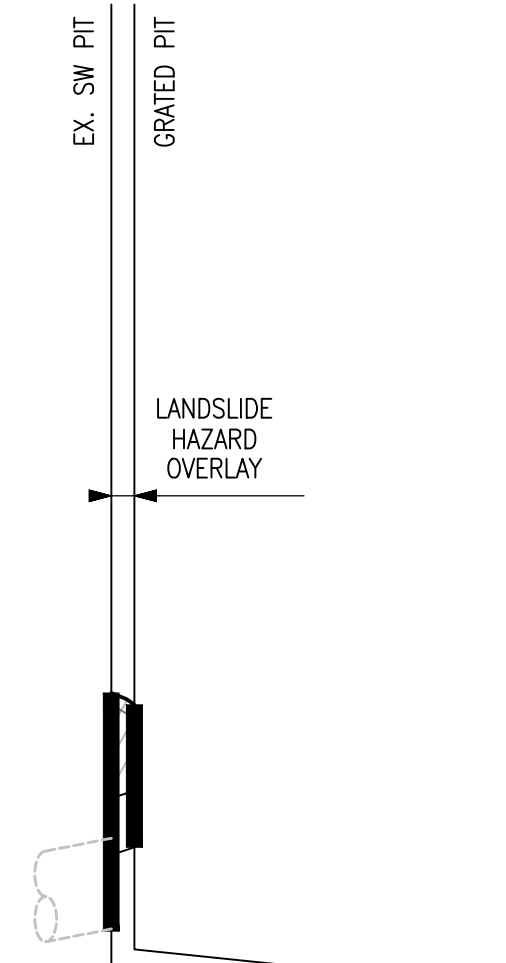

PIPE DETAILS GRADE		DN375 RCP 6.5%	
DATUM RL 28			
DEPTH TO INVERT	1.070		0.942
INVERT LEVEL	29.360 29.850		29.900
FINISHED SURFACE	30.920		30.842
EXISTING SURFACE	30.844		30.737
CHAINAGE	0.000	0.767	0.767

STORMWATER LINE 3

Kingborough Council
 Development Application: DA-2026-172
 Plan Reference No: P1
 Date Received: 7/5/2026
 Date placed on Public Exhibition: 13/6/2026

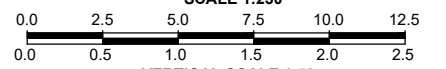
Copyright - "This document is and shall remain the property of Kingborough Council. The document may only be used for the purpose for which it was designed. Unauthorised use of this document in any way is prohibited". ©			
SCALE 1:250			
			
VERTICAL SCALE 1:50			
No.	DESCRIPTION	DATE	INITIAL
REVISIONS			
COORDINATE SYSTEM	GDA20 ZONE55	HEIGHT DATUM	AHD83
A3 ORIGINAL		DO NOT SCALE	

PREPARED BY ENGINEERING SERVICES			
SURVEYED	UDM	PROJECT ENGINEER	
DRAWN	T. BOWDEN	PROJECT MANAGER	
CHECKED			
DIRECTOR ENGINEERING SERVICES		/ / DATE	



Kingborough Council
 Civic Centre, 15 Channel Highway, Kingston, Tasmania 7050
 Postal Address: Locked Bag 1, Kingston, Tasmania 7050
 Telephone (03) 6211 8200 | Fax (03) 6211 8211
 Email kc@kingborough.tas.gov.au | Internet www.kingborough.tas.gov.au

BELHAVEN AVENUE (VIC 2-12), TAROONA
BETWEEN NORWOOD AVENUE AND MEATH AVENUE
RECONSTRUCTION
STORMWATER LONG SECTIONS

SHEET	17	OF	52	SHEETS
ACCOUNT:	C03645			
REV.				
CONTRACT/DRAWING NUMBER				
3281-117				

EX.PIT4/1 GDP4/2

EX.PIT4/1 GDP5/1

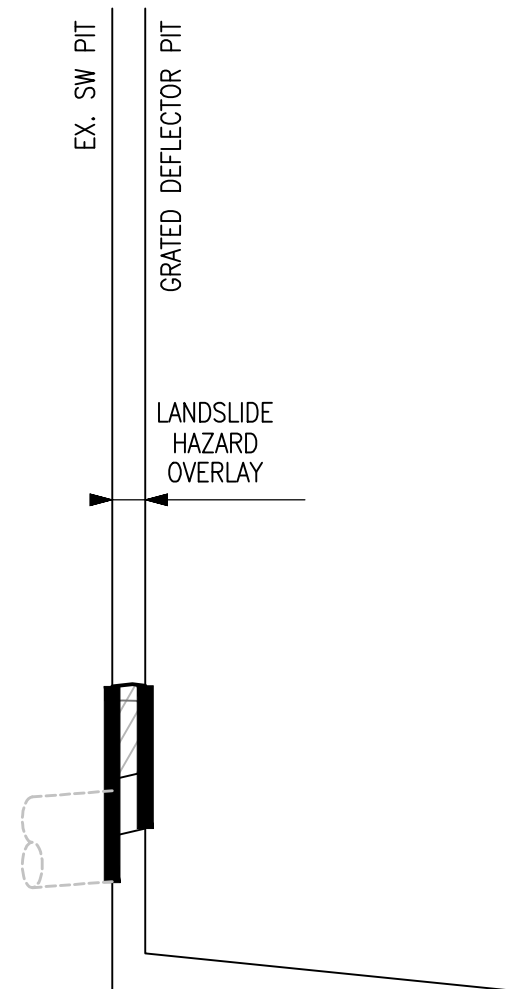
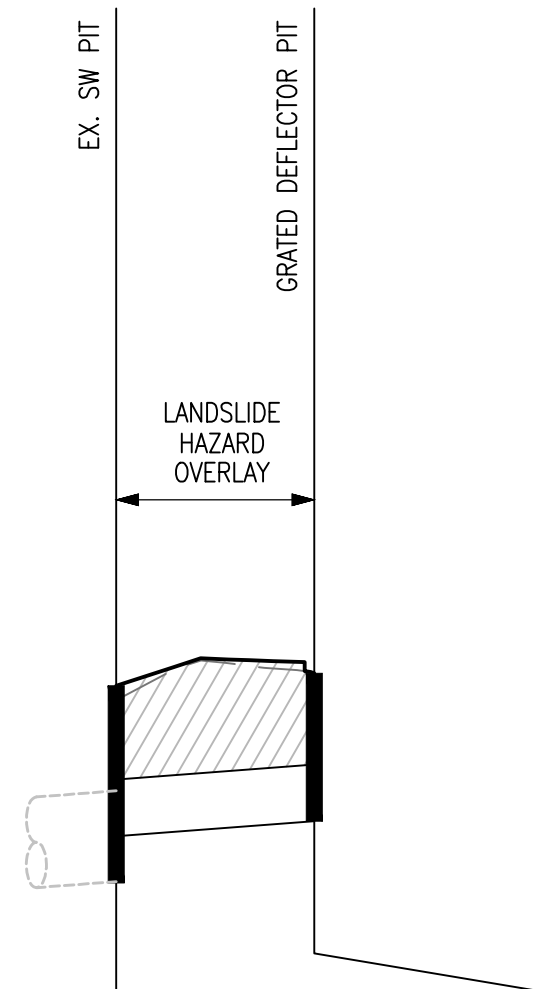

PIPE DETAILS		GRADE	
DATUM RL 32		DN375 RCP	
DEPTH TO INVERT	0.994		0.978
INVERT LEVEL	33.700 34.000		34.100
FINISHED SURFACE	34.994		35.078
EXISTING SURFACE	34.901		35.078
CHAINAGE	0.000	6.548	6.548

PIPE DETAILS		GRADE	
DATUM RL 32		DN375 RCP	
DEPTH TO INVERT	0.991		0.945
INVERT LEVEL	33.700 34.000		34.050
FINISHED SURFACE	34.991		34.995
EXISTING SURFACE	34.896		34.868
CHAINAGE	0.000	1.096	1.096

STORMWATER LINE 4

STORMWATER LINE 5

Kingborough Council
 Development Application: DA-2026-172
 Plan Reference No: P1
 Date Received: 7/5/2026
 Date placed on Public Exhibition: 13/6/2026

Copyright - "This document is and shall remain the property of Kingborough Council. The document may only be used for the purpose for which it was designed. Unauthorised use of this document in any way is prohibited". ©

SCALE 1:250
 0.0 2.5 5.0 7.5 10.0 12.5 m
 0.0 0.5 1.0 1.5 2.0 2.5
 VERTICAL SCALE 1:50

COORDINATE SYSTEM	GDA20_ZONE55	HEIGHT DATUM	AHD83
A3 ORIGINAL		DO NOT SCALE	

PREPARED BY ENGINEERING SERVICES			
SURVEYED	UDM	PROJECT ENGINEER	
DESIGNED	T. BOWDEN	PROJECT MANAGER	
DRAWN	T. BOWDEN		
CHECKED			
DIRECTOR ENGINEERING SERVICES		DATE	/ /



Kingborough Council
 Civic Centre, 15 Channel Highway, Kingston, Tasmania 7050
 Postal Address: Locked Bag 1, Kingston, Tasmania 7050
 Telephone (03) 6211 8200 | Fax (03) 6211 8211
 Email kc@kingborough.tas.gov.au | Internet www.kingborough.tas.gov.au

BELHAVEN AVENUE (VIC 2-12), TAROONA
BETWEEN NORWOOD AVENUE AND MEATH AVENUE
RECONSTRUCTION
STORMWATER LONG SECTIONS

SHEET	18	OF	52	SHEETS
ACCOUNT:	C03645			
REV.				
CONTRACT/DRAWING NUMBER				
3281-118				

DRAWING DETAILS: S:\technical Services\Job Folders\3281-117 to 118 Stormwater Long Sections.dwg
 PLOTTED: 06 March 2026 11:22 AM - KKONG
 Document Set ID: 4780907
 Version: 1, Version Date: 10/06/2026