

the BUSHFIRE HAZARD MANAGEMENT AREA (defendable space) as shown on this plan (shown hatched) has been designated between the dwelling and the risk and MUST be maintained / managed to reduce the spread of embers / flames / fires.

the implementation of this BUSHFIRE HAZARD MANAGEMENT PLAN must be carried out prior to occupancy of the new works.

- the occupant must
- keep grass / lawns to a length of less than 100mm, and maintain
  - remove fallen limbs, bark and litter from the BFHM area
  - not use flammable garden mulch such as pinebark
  - regularly thin out the under storey of trees and shrubs
  - prune low hanging tree limbs to create separation from flammable ground litter
  - prune larger trees to create canopy separation
  - remove and maintain flammable debris from gutters and around the building
  - construct non flammable driveways, paths and structures
  - keep fire wood storage to a minimum and greater than 6m from the building

planting establishment, where possible is to be primarily of low flammability shrubs species

Existing Fire Hydrant - 17m on nature strip of no.23 O'Connor Drive

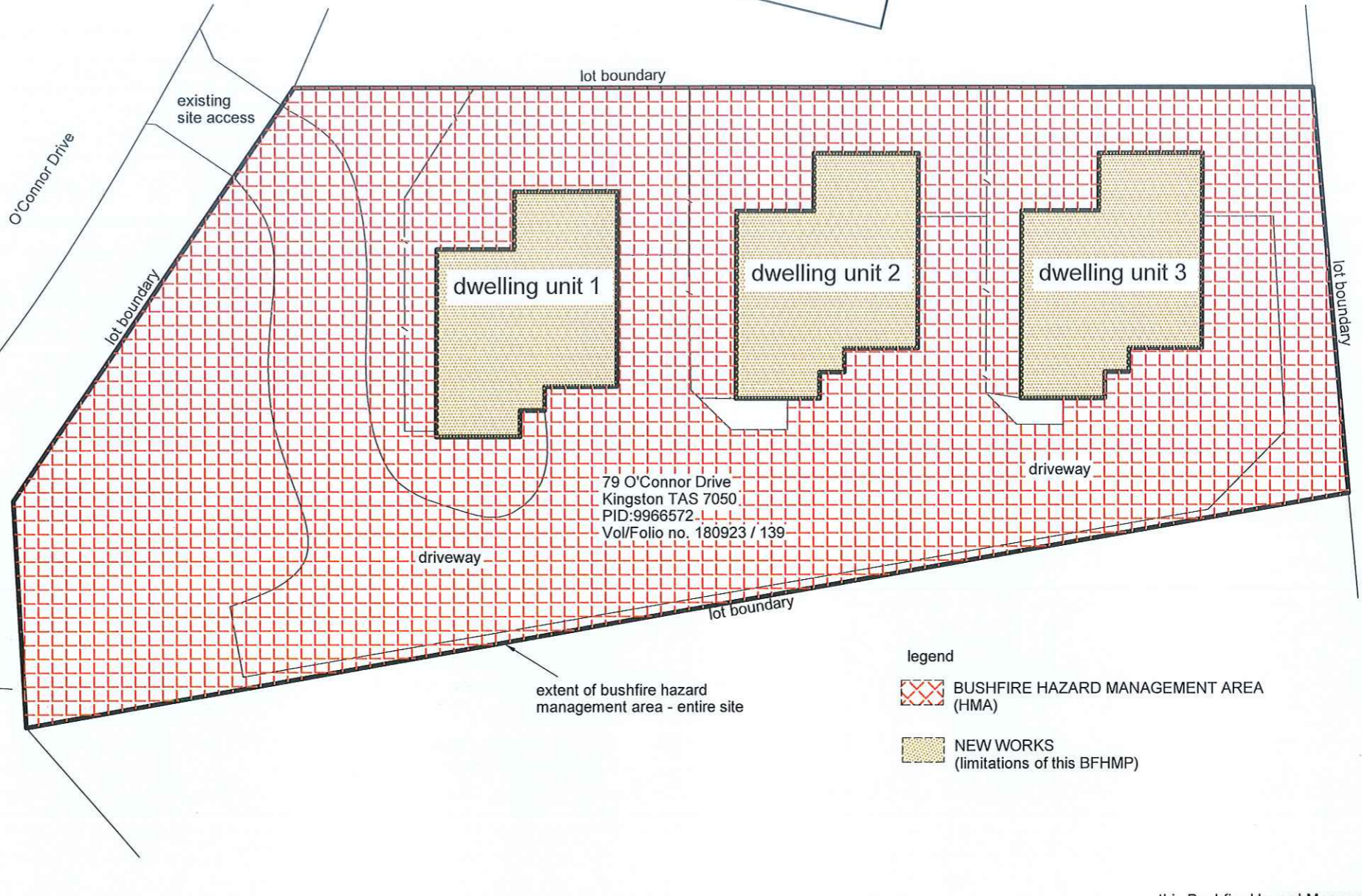

this BUSHFIRE HAZARD MANAGEMENT PLAN has been prepared for this site / dwelling works only and is only associated with this project and is to be read in line with report associated with this plan. failure to implement / continue the management of this plan may result in failure to comply with insurance requirements / conditions

**bal 12.5 - UNITS 1,2 & 3**

**bushfire hazard management plan**  
SCALE: 1:250 approx

- legend
- BUSHFIRE HAZARD MANAGEMENT AREA (HMA)
  - NEW WORKS (limitations of this BFHMP)

this Bushfire Hazard Management Plan is to be read in conjunction with report no.8374 prepared by Jason Van Zetten Accreditation no. BFP113 scope of work 1,2,3A

this Bushfire Hazard Management Plan has been prepared by Jason Van Zetten Accreditation no. BFP113 scope of work 1,2,3A

A COPY OF THIS DOCUMENT MUST BE PROVIDED TO ALL CURRENT & SUCCESSIVE OWNERS TO MAKE THEM AWARE OF THEIR OBLIGATIONS OF CONTINUING MAINTENANCE AND BUSHFIRE ASSOCIATED RISK

<small>© THESE DRAWINGS ARE PROTECTED BY COPYRIGHT LAW AND ARE NOT TO BE COPIED IN ANY FORM, OR USED FOR ANY ADVERTISING PURPOSES (INCLUDING INTERNET ADVERTISING) WITHOUT WRITTEN PERMISSION OF JASON VAN ZETTEN</small>	amendment	bushfire hazard management plan for: Harman Verma lot: 139 no.79 O'Connor Drive Kingston	dwg no. BFHMP - 8374	version - 01
	1.		sheet: 01 of 01	print date
	2.		date: May 2026	9 MAY 2026
	3.		scale: 1:250 @ A3 approx	
	4.		bal: 12.5	drawn: JVZ



- BUSHFIRE SITE ASSESSMENTS
- BUSHFIRE REPORTS
- HAZARD MANAGEMENT PLANS
- SHORT TERM ACCOMODATION

PH 0429 199 934  
www.reddogbushfire.com.au