

Site plan showing contours and lot dimensions

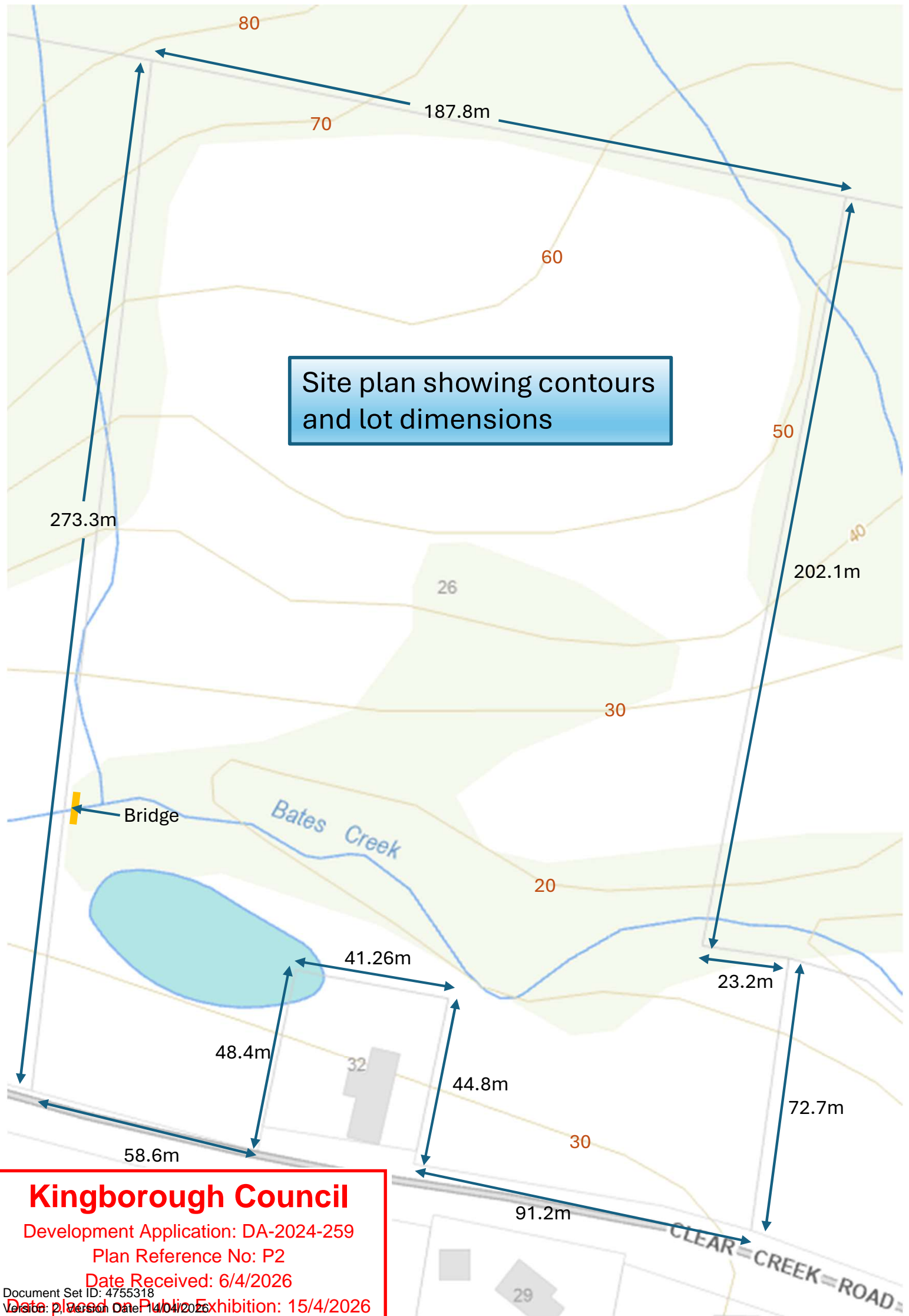

Kingborough Council

Development Application: DA-2024-259

Plan Reference No: P2

Date Received: 6/4/2026

Document Set ID: 4755318
Version: 2, Version Date: 14/04/2026
Date placed on Public Exhibition: 15/4/2026

Kingborough Council

Development Application: DA-2024-259

Plan Reference No: P2

Date Received: 6/4/2026

Date placed on Public Exhibition: 15/4/2026

Site plan showing existing buildings and residence (taken from approved Form 2 CLC)

OPEN GRASS PADDOCK

BATES CREEK

BRIDGE

WOODLAND FOREST AREA

EXISTING DAM

OPEN GRASS PADDOCK

ADJOINING RESIDENCE

OPEN GRASS PADDOCK

BUILDING ENVELOPE

PROPOSED RESIDENCE

PROPOSED CARPORT

Note - residence is now constructed and occupied

Site plan showing setbacks and bridge dimensions

191.7m to North boundary

1.1m to West boundary

Bridge – 12m x 2.2m

175m to East Boundary

68.1m to South boundary

Bates Creek

CLEAR CREEK ROAD

91.2m

Kingborough Council

Development Application: DA-2024-259

Plan Reference No: P2

Date Received: 6/4/2026

Date placed on Public Exhibition: 15/4/2026

Document Set ID: 4755318

Version: 2 | Version Date: 14/04/2026

“1. (b) Elevation plan showing the proposed bridge alterations and the extent of site works, including maximum height of the structure and depth of any cut or fill (see also further details requested in item 3 below), the extent of rockwork, and accurately identifying the width and depth of Bates Creek.”

Elevation plan below.

